



HONG KONG COUNTRY CLUB







THE HONG KONG COUNTRY CLUB REDEFINES  
EXTRAORDINARY

Overlooking the spectacular Deep Water Bay and only minutes away from the hustle and bustle of the city, the Hong Kong Country Club is the ideal choice for both grand functions and intimate gatherings.

The Club's versatile outdoor and indoor event spaces with breathtaking boundless sea views, delectable menu options and meticulous service provided by our professional event planning experts make any celebration special and memorable.



*Welcome*  
*to*  
*Hong Kong Country*





Welcome

Country Club





## IL PONTE

Elevating your al fresco event experience with its jaw-dropping panoramic sea views and an ambience of relaxed elegance, Il Ponte is the perfect location for your dream wedding, intimate family gatherings, themed celebrations and retreats.















## THE LAWN

The Lawn, with its idyllic view overlooking Deep Water Bay, has always been and continues to be one of the most enviable venues for extravagant weddings and ceremonies, private parties and lavish events in Hong Kong. The well-maintained stretch of green lawn creates a truly one-of-a-kind waterfront lush oasis that makes any celebration legendary.





## UPPER DECK

The tranquil open-air Upper Deck is perfect for hosting intimate events or for celebrating special occasions with your loved ones. With warm sunshine, refreshing sea breeze and a magnificent view, the breezy patio is perfect for those seeking a destination that embraces both nature and luxury.











## POOLSIDE GARDEN

The Poolside Garden is an outdoor oasis making it perfect for hosting laidback get-togethers, intimate parties or barbeques.



## TREETOPS

Designed for small-scale meetings and social gatherings, Treetops is a uniquely secluded space surrounded by greenery, offering complete privacy and discretion for you and your guests. Fuel your attendees with a bespoke menu to your exacting requirements, while our dedicated staff ensure every detail of your event is professionally managed.







## BAYVIEW ROOM

Located on the 1<sup>st</sup> floor of the Club, the versatile Bayview Room can be easily transformed into three multi-purpose function rooms - Bayview Room I, II & III - offering a range of elegant settings suitable for any functions and occasions - from birthday celebrations to corporate meetings. Overlooking the sweeping views of Deep Water Bay, the Bayview Room features wraparound windows which invite an abundance of natural light.























## MAIN LOUNGE

The fabled Main Lounge has long been home to legendary events, lavish gala dinners, grand wedding receptions and other festivities that redefine luxury. Filled with natural sunlight, the warm and welcoming space provides an ambiance that feels sophisticated and glamorous. As the Club's largest indoor venue, it accommodates as many as 200 people with multiple set up opportunities. Paired with tailor-made menus, advanced audio-visual technology and personalized service, the Main Lounge is the ideal destination for celebrations and functions of all types and sizes.











GROUND FLOOR  
& OUTDOOR





## GROUND FLOOR

	Main Lounge	Island Room	Patio I or II	Patio I + II	Golden I or II	Golden I + II
Floor Area	411.8 sq m	293.1 sq m	19.7 / 23.3 sq m	43 sq m	35.1 / 31.4 sq m	94 sq m
Ceiling Height	2.7 - 3.3 m	2.7 - 3.2 m	2.7 - 3.2 m	2.7 - 3.2 m	2.9 m	2.9 m
<i>Capacity</i>						
Western Dinner	216	84	12	24	12	36
Chinese Dinner	216	84	12	24	12	36
Dinner + Dance Floor	180	60	-	-	-	-
Buffet	156	84	-	-	-	26
Cocktail + Dance Floor	200	100	-	-	-	-
Classroom	45	54	-	-	-	36
Theatre	125	120	-	36	-	50
Boardroom	-	-	-	22	22	30
U-shape	-	-	-	-	-	29

## OUTDOOR

	The Lawn	Il Ponte	Upper Deck	Poolside Garden	Poolside Kiosk Deck
Floor Area	-	250 sq m	392.9 sq m	195.1 sq m	98.6 sq m
<i>Capacity</i>					
Western Dinner	120	-	-	-	-
Dinner + Dance Floor	120	-	-	-	-
Buffet	300	36	100	36	25
Cocktail + Dance Floor	250	50	100	40	-
Theatre	240	50	-	-	-



# 1<sup>ST</sup> FLOOR

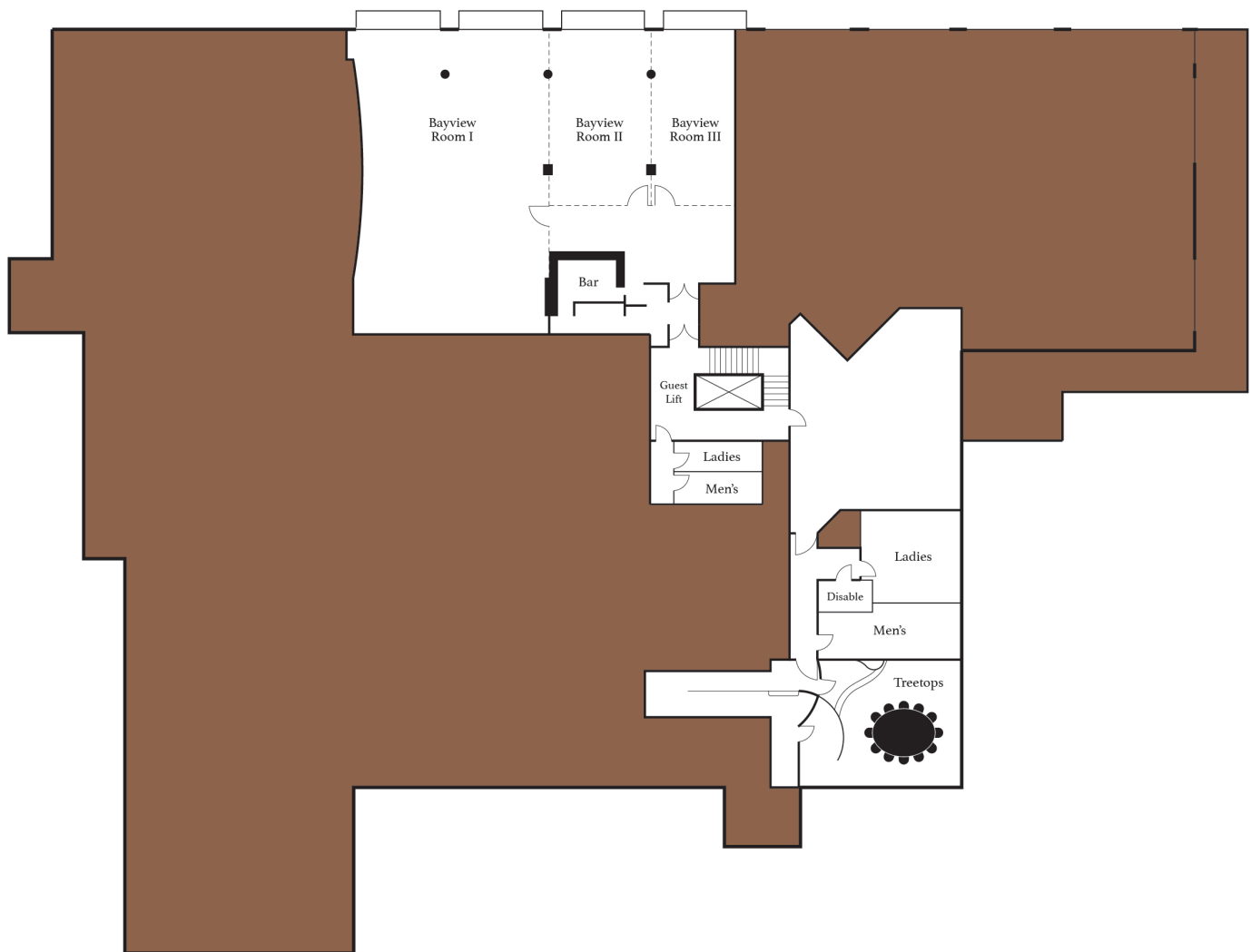



1<sup>ST</sup> FLOOR

	Bayview I	Bayview II	Bayview III	Bayview II + III	Bayview I + II+ III	Treetops
Floor Area	146.9 sq m	51.4 sq m	39.8 sq m	91.2 sq m	286.6 sq m	35 sq m
Ceiling Height	2.2 - 4 m	2.2 - 4 m	2.2 - 4 m	2.2 - 4 m	2.2 - 4 m	2.3 m
Capacity						
Western Dinner	72	24	12	36	120	16
Chinese Dinner	72	24	12	36	120	-
Dinner + Dance Floor	60	-	-	-	120	-
Buffet	60	-	-	-	96	-
Cocktail + Dance Floor	50	-	-	-	120	-
Classroom	45	12	12	24	54	-
Theatre	80	30	20	50	130	-
Boardroom	38	22	20	22	38	-
U-shape	38	-	-	-	38	-



## PLAN YOUR JOURNEY WITH US

When everything must be absolutely perfect for your event, function or meeting, you can trust the expertise of the Club's events team. A flawless experience is right at your fingertips.

For details about hosting your next event or meeting at the Hong Kong Country Club, please contact our Events and Catering Team at 2870 6396 or email to [banquet@countryclub.hk](mailto:banquet@countryclub.hk).

*Remarks: All pictures shown in this brochure are for illustration purpose only.*



188 Wong Chuk Hang Road, Deep Water Bay, Hong Kong SAR

T: +852 2870 6396

E: [banquet@countryclub.hk](mailto:banquet@countryclub.hk)

[www.countryclub.hk](http://www.countryclub.hk)









HONG KONG COUNTRY CLUB